

Scenic "Space-Ship" Deck Plan

ms Scenic Sapphire, ms Scenic Emerald, ms Scenic Diamond and ms Scenic Ruby

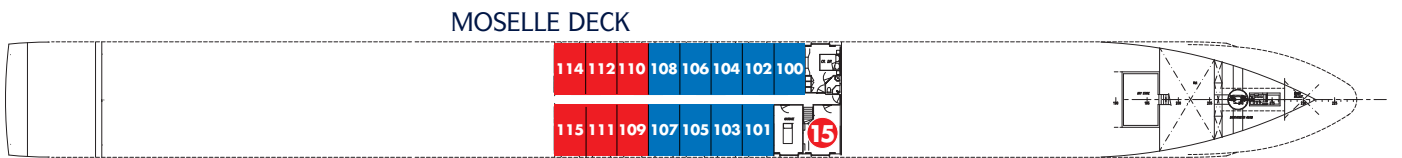
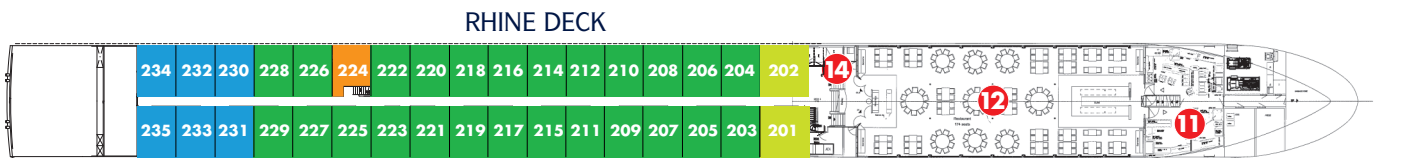
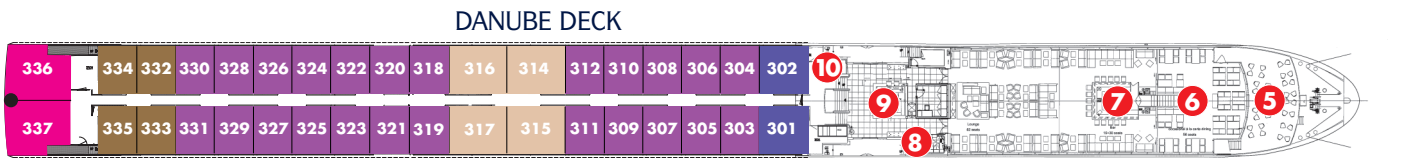
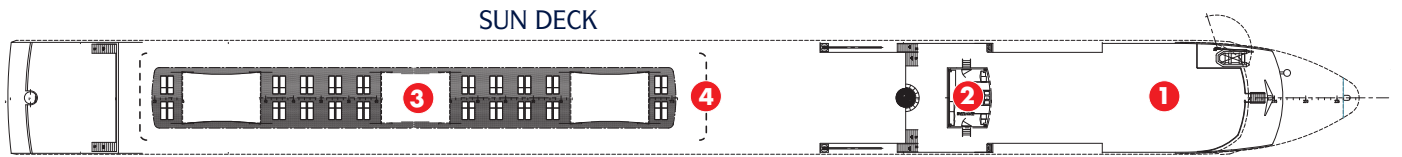
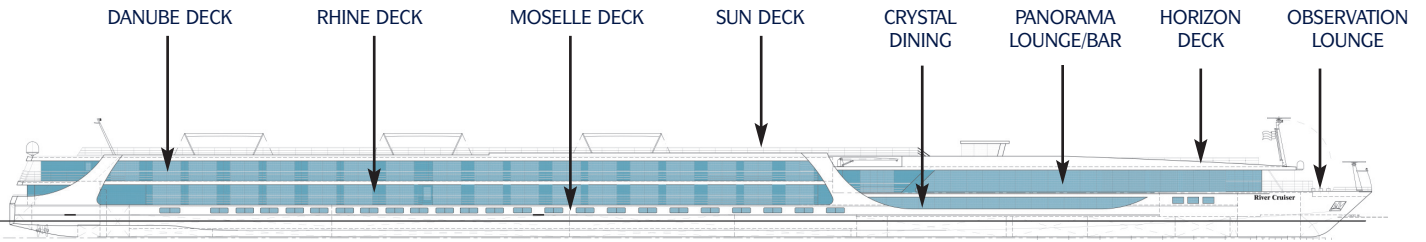

TECHNICAL DATA

Built: 2008/2009
 Length: 135 metres
 Passengers: 169
 Cabins: 85
 Crew: 48

DECK PLAN

- 1 Observation Deck
- 2 Wheel house
- 3 Sun Deck
- 4 Walking Track
- 5 Observation Lounge
- 6 Portobello's Restaurant
- 7 Panorama Lounge & Bar
- 8 Gift Shop
- 9 Reception
- 10 Elevator
- 11 Kitchen
- 12 Crystal Dining Restaurant
- 14 Elevator
- 15 Wellness Area

CABIN CATEGORIES

DANUBE DECK

- R Cat. Royal Balcony Suite
- S Cat. Junior Balcony Suite
- RJ Cat. Junior Balcony Suite
- P Cat. Balcony Suite
- A Cat. Balcony Suite

RHINE DECK

- BJ Cat. Junior Balcony Suite
- BS Cat. Balcony Suite (single)
- B Cat. Balcony Suite
- C Cat. Balcony Suite

MOSELLE DECK

- D Cat. Standard stateroom
- E Cat. Standard stateroom

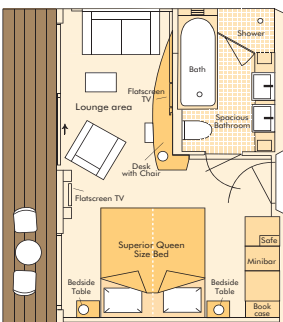

Royal Suite 27.5m²/300ft²
(R Category)

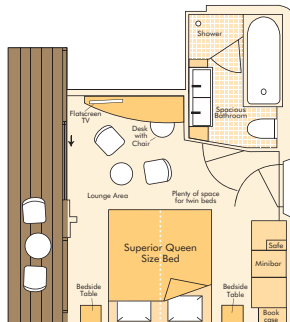

Junior Suite 23m²/250ft²
(RJ, BJ Category)

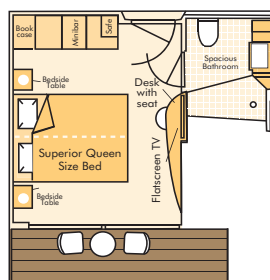

Private Balcony Suite 18.5m²/200ft²
(P, A, B, C Category)

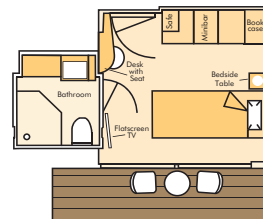

Private Balcony Suite
Single Cabin 11.7m²/129ft²
(BS Category)

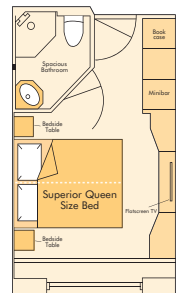

Moselle Deck 15m²/160ft²
(D and E Category)

Cabin plan for S category Junior Suite and RJ Junior Suite (302) differs from the above diagram and is available on request.

Junior Suite 302 does not have a bath. The cabin layouts, cabin sizes and deckplan are correct at the time of printing but may vary.